

**ELECTRIC ROLLER SHUTTER / AWNING BLIND****ARZ Komfort WiFi Tuya  
AMZ WiFi Tuya  
VMZ WiFi Tuya**

ARZ Komfort WiFi Tuya

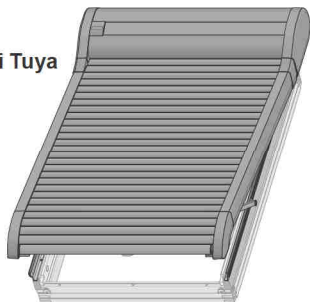

AMZ WiFi Tuya

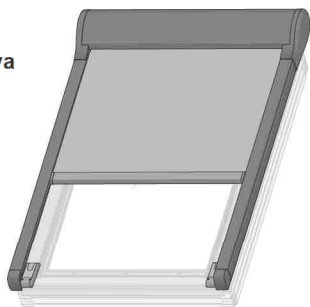

VMZ WiFi Tuya

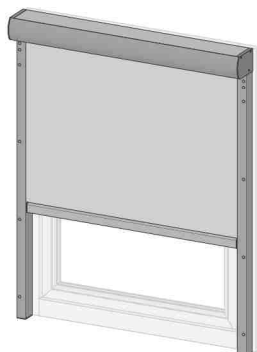

IMPORTANT INFORMATION	2
CONNECTION DIAGRAM	3
CONTROL PANEL	3
MANUAL CONTROL	5
WiFi DEVICES COMPATIBILITY	5
DECLARATION OF CONFORMITY	5
QUICK START	6
WARRANTY	7



<http://www.fakro.com/download/film-installation-instructions/roof-windows/>

The electrically operated ARZ Komfort roller shutter / AMZ, VMZ WiFi Tuya awning blind ensure maximum comfort of using the attic space. Control your product by means of smartphone app locally or from anywhere in the world. Set the comfort position, create a schedule to suit your needs and control the status of your product. Share products with household members.

TECHNICAL SPECIFICATION			
ARZ Komfort WiFi Tuya	AMZ WiFi Tuya	VMZ WiFi Tuya	ARZ Komfort, AMZ, VMZ WiFi Tuya
<b>Power supply:</b> 15V DC <b>Power:</b> 20W <b>Working temperature:</b> -20°C to 185°C <b>Power cable:</b> 2 x 0.75 mm <sup>2</sup>	<b>Power supply:</b> 15V DC <b>Power:</b> 20W <b>Working temperature:</b> -20°C to 185°C <b>Power cable:</b> 2 x 0.75 mm <sup>2</sup>	<b>Power supply:</b> 15V DC <b>Power:</b> 35W <b>Working temperature:</b> -20°C to 185°C <b>Power cable:</b> 2 x 0.75 mm <sup>2</sup>	<b>Radio protocol:</b> WiFi <b>Radio frequency:</b> 2.4 GHz <b>Reach:</b> up to 20 m in a building

### IMPORTANT INFORMATION

Please read carefully the instructions below before proceeding to product installation so as to prevent electric shock, injury, etc.

It is required to observe the following recommendations when installing electrically operated roller shutter:

- After unpacking, check the device for its correct operation (applying to ARZ Komfort and AMZ WiFi Tuya). Place the device in flat position and connect to the 15VDC power supply. The power supply unit must be purchased separately. Run the device using the manual control button.
- Install the device according to the fitting instructions.
- Connect the device to the low voltage system according to the diagram contained in this user manual. Installation should be carried out in accordance with the manufacturer's instructions by a qualified professional. Check the correct operation with one cycle using the manual control button.
- Add the device to your app in accordance with the programming instructions.
- The device should be used according to its intended design.
- In the event of adverse weather conditions (frost, snow) it may not be possible to operate the device.
- The device is equipped with protections: mechanical limiting and current limiting to provide protection against damage in the event of an obstacle or when starting a snow-covered product at low temperature. The mechanical limiting protections of the device are factory set.
- It is recommended to separate the WiFi 2.4GHz and 5GHz network bandwidth with another SSID.

## CONNECTION DIAGRAM

Connect the ARZ Komfort roller shutter / AMZ, VMZ WiFi Tuya awning blind to the ZZ60h or ZZ60 power supply according to the diagram below. A maximum of two roller shutters / awning blinds can be connected to one power supply. The power supply must be purchased separately.

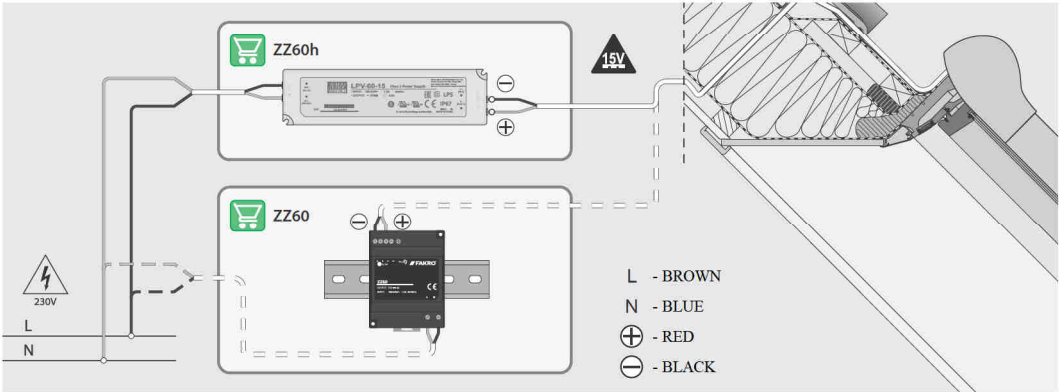

## CONTROL PANEL

### ARZ Komfort WiFi Tuya

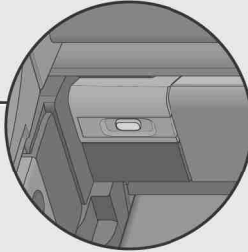
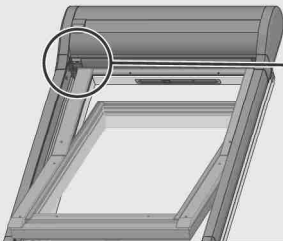

- WiFi NETWORK / MOTOR STATUS LED  
- PROGRAMMING / MANUAL CONTROL BUTTON

### AMZ WiFi Tuya

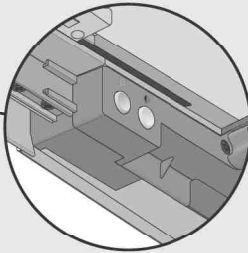
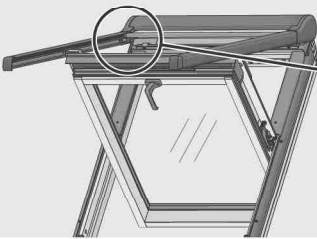

**P**



- WIFI NETWORK STATUS LED  
- PROGRAMMING BUTTON



- MOTOR STATUS LED  
- MANUAL CONTROL BUTTON

### VMZ WiFi Tuya

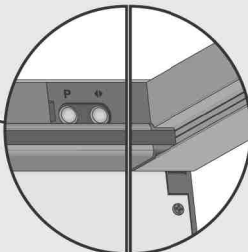
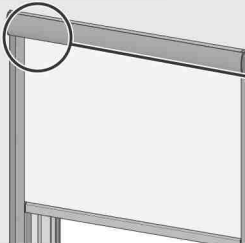

**P**



- WIFI NETWORK STATUS LED  
- PROGRAMMING BUTTON



- MOTOR STATUS LED  
- MANUAL CONTROL BUTTON

## CONTROL PANEL FUNCTIONS ARZ Komfort WiFi Tuya

### BASIC FUNCTIONS

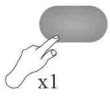

Press the button once.  
Manual control.



Hold the button for 5 sec.  
Entering the AP programming mode.

### SIGNALLING



Red LED blinks once.  
Reaching the upper or lower end position.



Red LED blinks 3 times.  
Overload.



The roller shutter lights up after power reset.  
Unconfirmed upper end position.  
After activation, LED blinks until the reference position is reached.

## CONTROL PANEL FUNCTIONS AMZ WiFi Tuya, VMZ WiFi Tuya

### BASIC FUNCTIONS

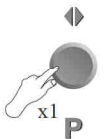

Press the control button once.  
Manual control.



Hold the button for 5 sec.  
Entering the AP programming mode.

### SIGNALLING



LED blinks once.  
Reaching the upper or lower end position.



LED blinks 3 times.  
Overload.

## MANUAL CONTROL

### ARZ Komfort WiFi Tuya

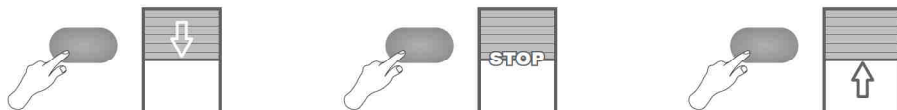

Control the device by pressing the button: 1. Start, 2. Stop, 3. Start in the opposite direction...

### AMZ, VMZ WiFi Tuya

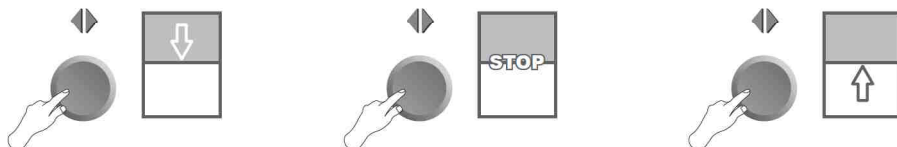

Control the device by pressing the manual control button: 1. Start, 2. Stop, 3. Start in the opposite direction...

## WiFi DEVICES COMPATIBILITY

The WiFi makes it possible to integrate devices of different categories (lighting, heating, domestic automatic control, etc.). This product can be operated in any WiFi network. A router with Internet access is required.

 All information on adding devices to the Wi-Fi network can be found in user manuals of these products.

 This product is compatible with Tuya Smart and Smart Life app.

## DECLARATION OF CONFORMITY

FAKRO Sp. z o.o. hereby declares that a type of radio device ARZ Komfort WiFi Tuya, AMZ WiFi Tuya, VMZ WiFi Tuya complies with the RED Directive 2014/53/EU.

The full text of the EU Declaration of Conformity can be found at:  
<https://www.fakro.com/ce-declarations/search/>



### COMPLIANCE WITH THE WEEE DIRECTIVE

Devices marked with this symbol must not be disposed of or thrown away as household waste. It is the user's responsibility to deliver devices that are worn out to the designated recycling area.

## QUICK START

### FAKRO smartHome APP DOWNLOAD

Download the FAKRO smartHome app using QR code or install it from Google Play or App Store.



ANDROID



IOS

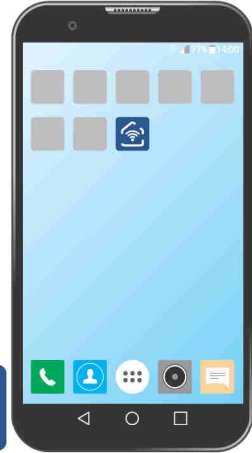

Follow the installer's instructions.

The app shortcut will be added to the home screen.

### FAKRO smartHome INSTRUCTIONS



Scan QR code and go to the instructions of FAKRO smartHome app.



The ARZ Komfort WiFi Tuya roller shutter is factory calibrated.  
Recalibration of the roller shutter can be performed from the app in the device settings.

# WARRANTY



PL

<https://www.fakro.pl/serwis/gwarancja/>



GB

<https://www.fakro.com/service/customer-service/>

## FAKRO Sp. z o.o.

Ul. Węgierska 144A, 33-300 Nowy Sącz  
Polska  
[www.fakro.com](http://www.fakro.com)  
tel.+ 48 18 444 0 444, fax. +48 18 444 0 333

### Quality certificate:

Device

---

Model

---

Serial number

---

Seller

---

Address

---

Purchase date

---

Invoice No.

---

Signature (stamp) of person installing a device

